

ARTIKELNUMMER

WSA8012302

WSA8012402

WSA1010302

WSA1208400

WSA1210302

WSA1212302

WSA1212402

WSA1410302

WSA1410402

Dieses Produkt ist ein Leergehäuse für Niederspannungs-Schaltgerätee Anwendungen mit einer maximalen Nennspannung von 1000V AC oder 1500V DC für den Innenbereich



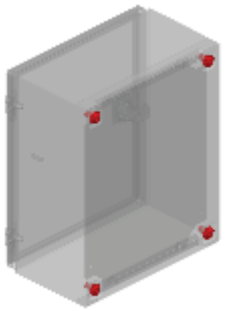

MONTAGE VON SCHRAUBEN UND DICHTUNGEN

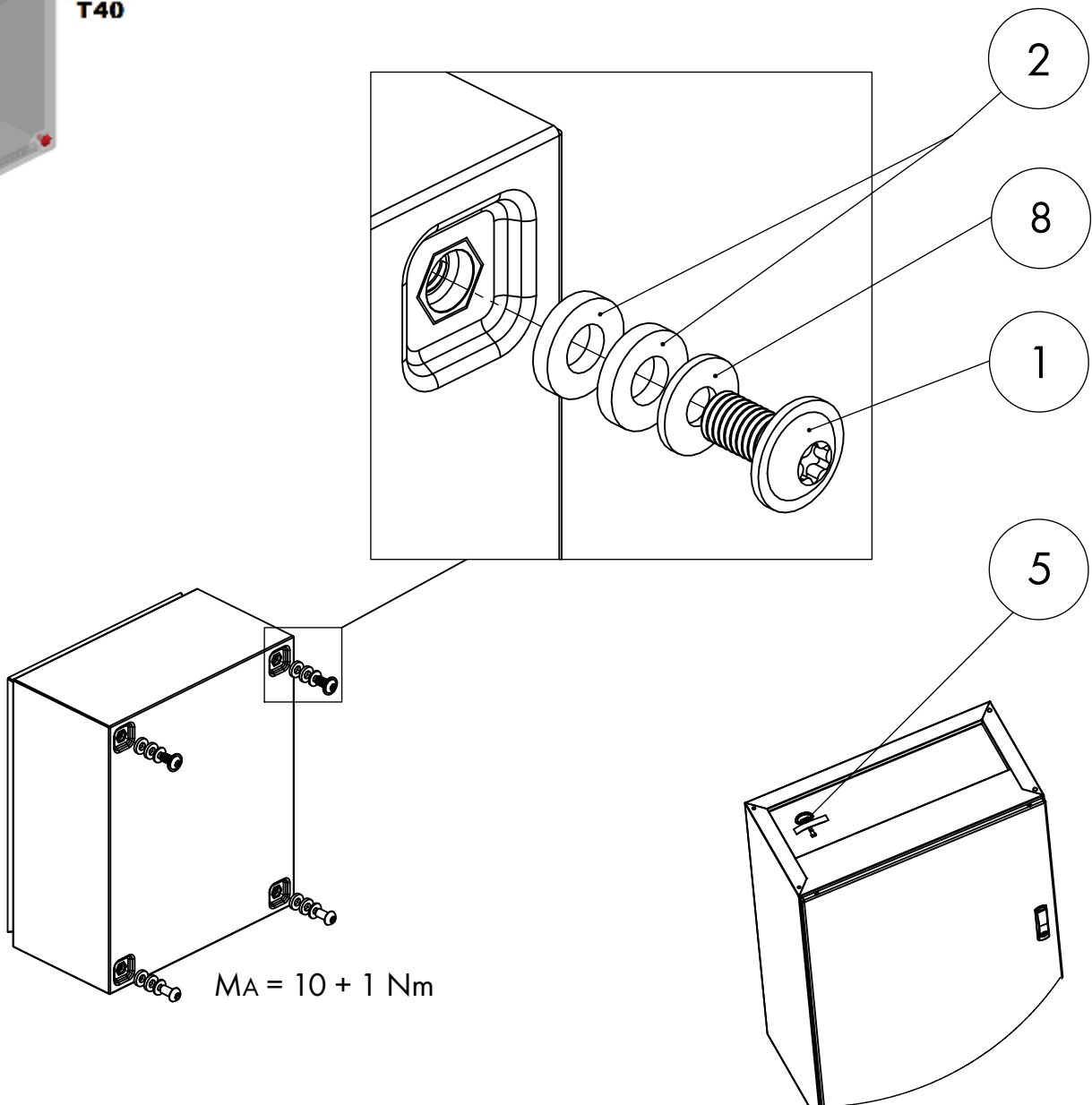

LIEFERUMFANG

Nr.			Stk.	Nr.			Stk.
1		M8x16mm	4	6		M8x15mm	1
2		Dichtung Ø16x8mm	8	7		M8	1
3		M6	E: 3 Z: 6	8		Unterlegscheibe M8	5
4		M6	E: 3 Z: 6	9		Sticker	E: 4 Z: 7
5		Doppelbartschlüssel	1				

E=Eintürig

Z=Zweitürig

MONTAGEPLATTENBEFESTIGUNG

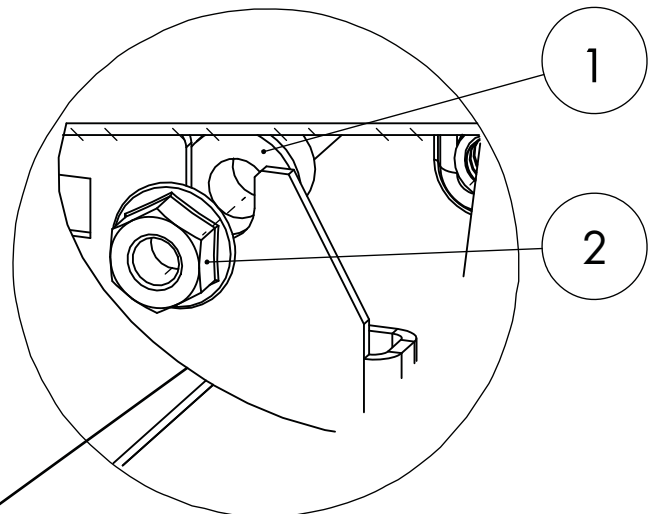
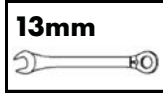
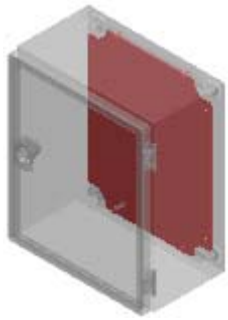

MA = 8 + 1 Nm

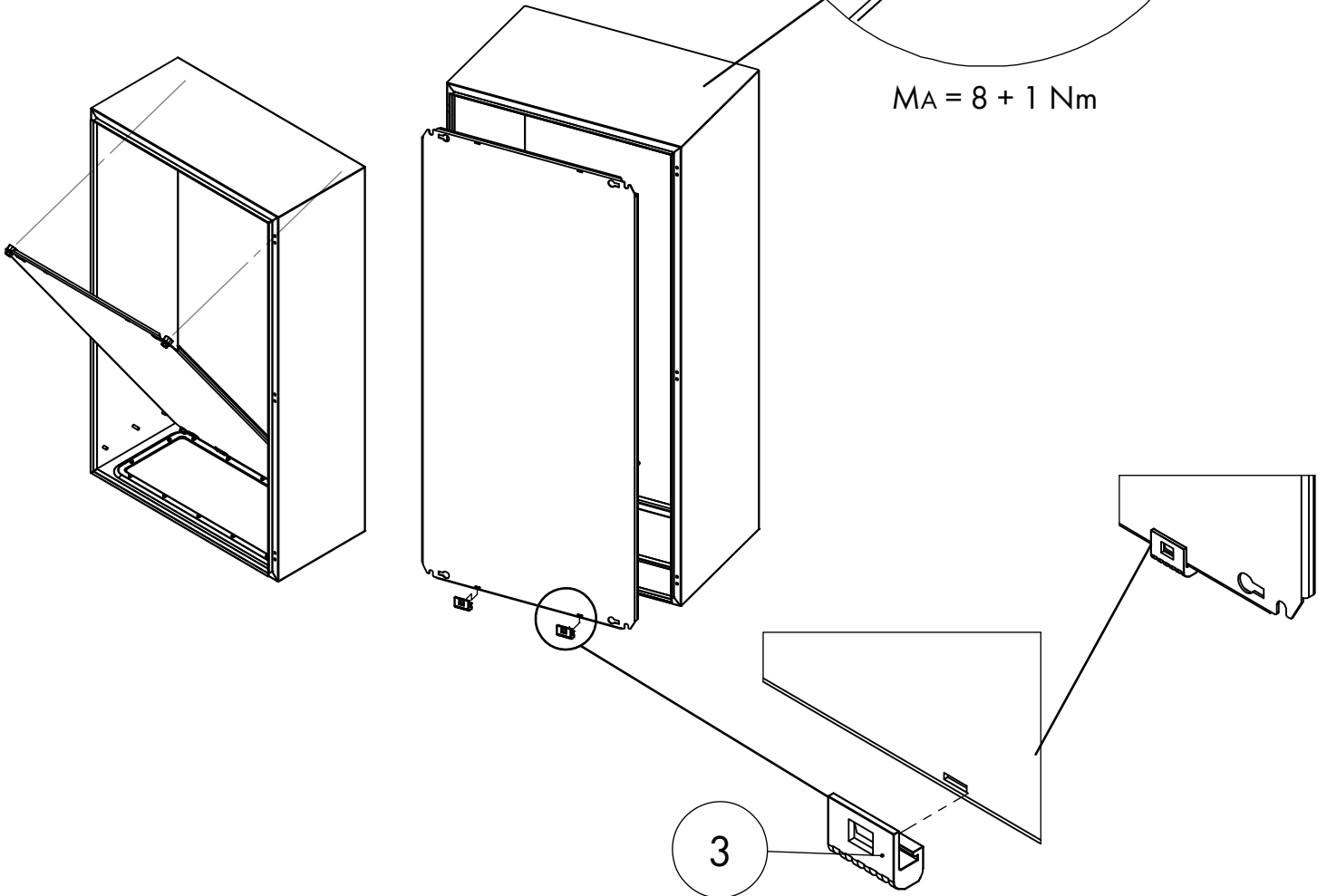

Nr.			Stk.
1		M8x11 mm	4
2		M8	4
3		Montageplattenhalterung	2
			Ab Breite 1000mm: 3

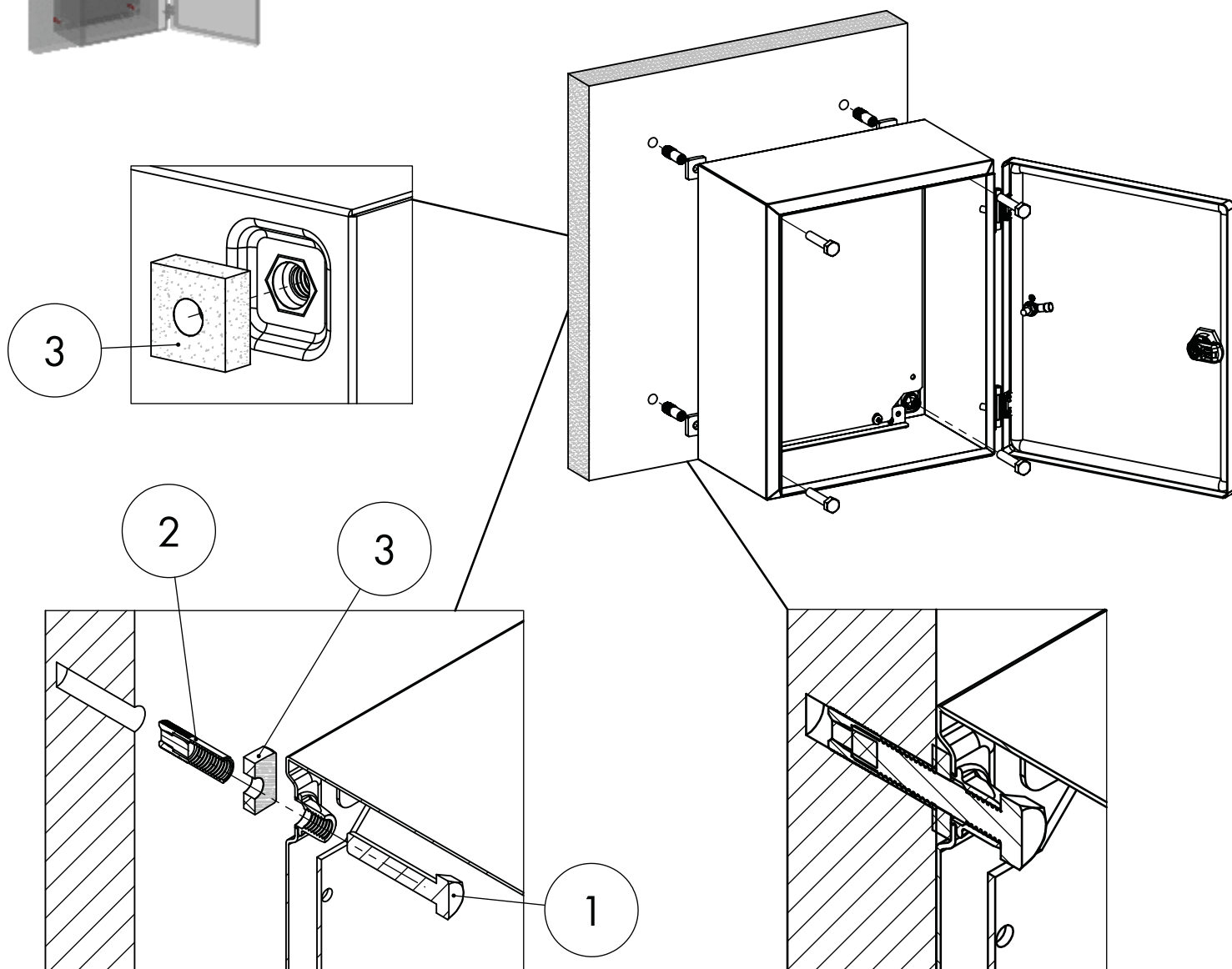
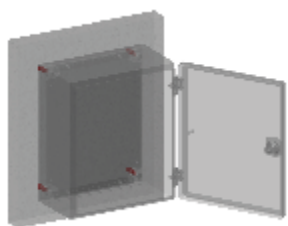

DIREKTE MONTAGE

13mm

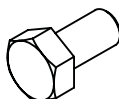

MA = 8 + 1 Nm

i **ERFORDERLICHE TEILE (Nicht im Lieferumfang enthalten!)**

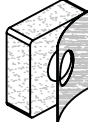
Nr.			Stk.
1		M8	4
2		Stahldübel M8	4
3		Selbstklebende Dichtung	4

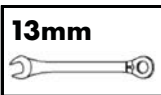

MONTAGE AUF PROFILSCHIENEN

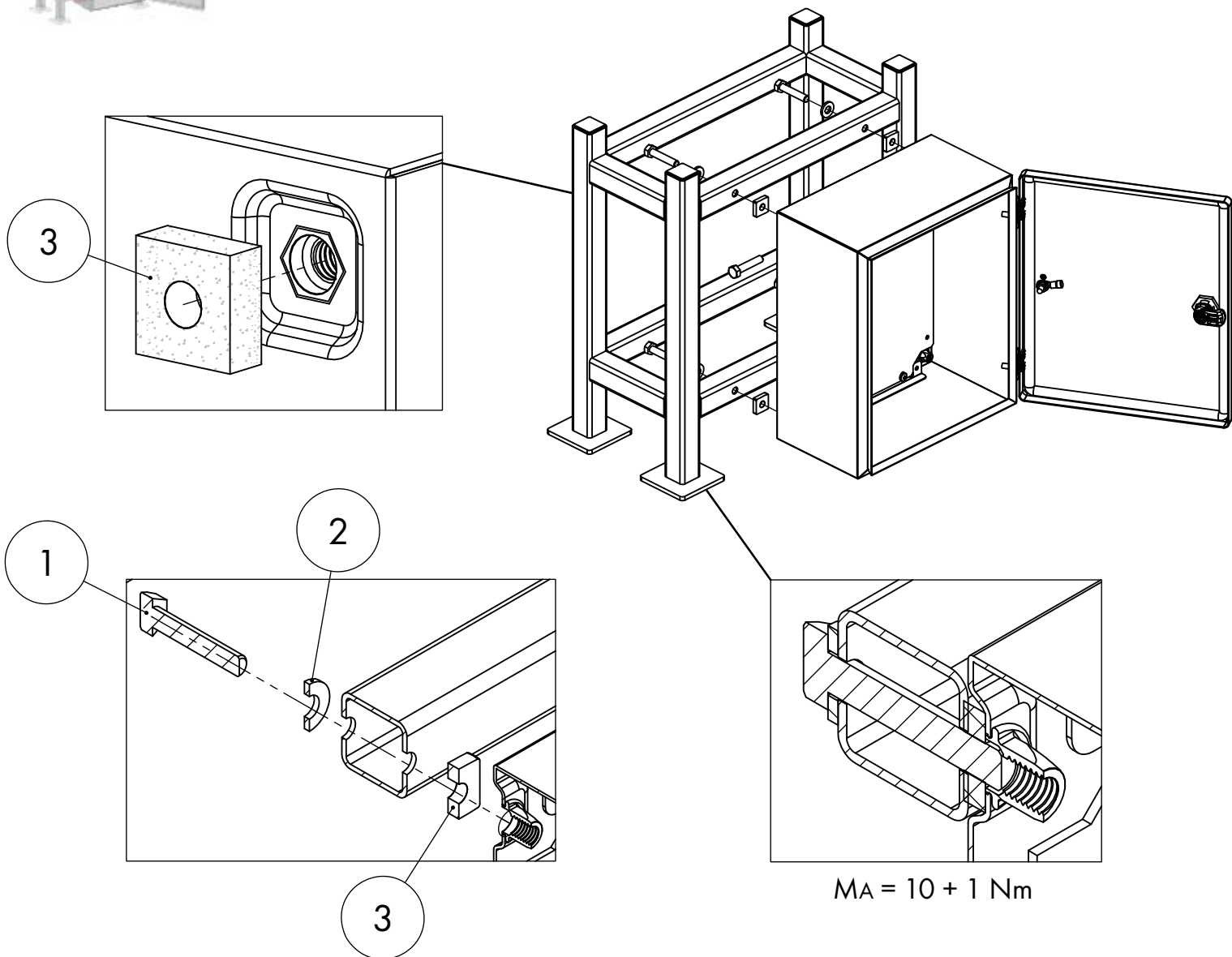

i **ERFORDERLICHE TEILE (Nicht im Lieferumfang enthalten!)**

Nr.			Stk.
1		M8	4
2		Unterlegscheibe M8	4
3		Selbstklebende Dichtung	4

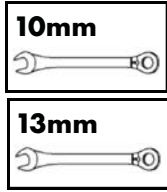
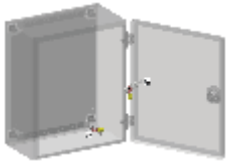

ERDUNG

